

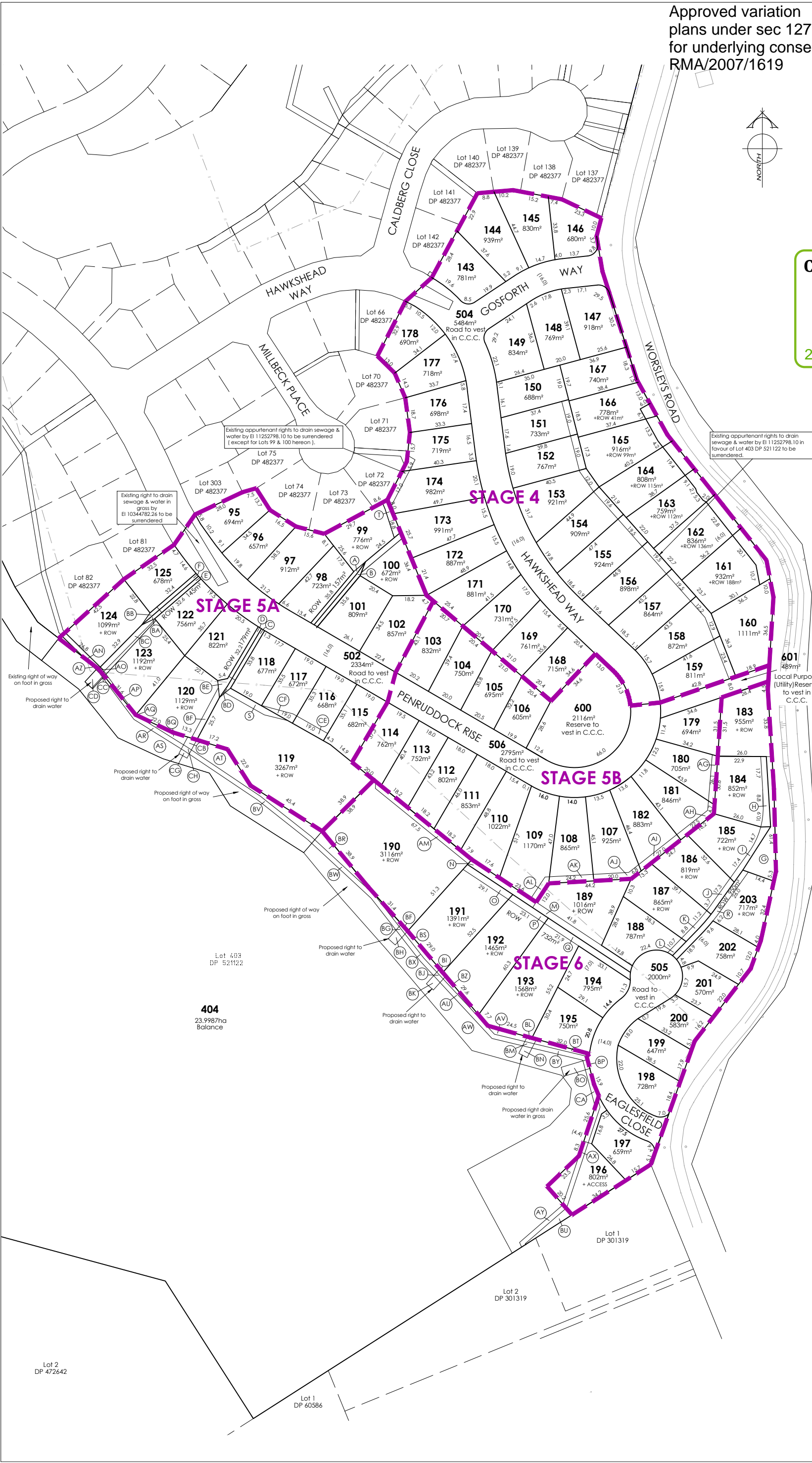

Approved variation plans under sec 127 - for underlying consent RMA/2007/1619



AMENDMENTS:		
AMENDMENT	DATE	DESCRIPTION
R4	21.09.20	ADDED STAGES 5A & 5B
R5	9.11.20	LOTS 116, 117, 124 & 404 EASEMENTS AMENDED
R6	19.01.21	LOTS 196 AND 197 EASEMENTS AMENDED
R7	20.5.21	LOTS 183 - 188, 198 - 203 & 505 AMENDED

- NOTES:
- 1) Areas and dimensions are subject to final survey and deposit of plans.
 - 2) Service easements to be created as required.
 - 3) This plan has been prepared for subdivision consent purposes only. No liability is accepted if the plan is used for any other purpose.
 - 4) This plan has been prepared for the use of our client and no liability is accepted in relation to any other parties.
 - 5) Any measurements taken from information which is not dimensioned on the electronic copy are at the risk of the recipient.
 - 6) This plan is subject to the granting of subdivision and/or resource consents and should be treated as a proposal until such time as the necessary consents have been granted by the relevant authorities.

Christchurch City Council  Page 1 of 2
RMA/2007/1619/F
Approved Resource Consent Plan
 21/06/2021 James John

PROPOSED MEMORANDUM OF EASEMENTS			
Nature	Servient Tenement (Burdened Land)		Dominant Tenement (Benefited Land)
	Lot No.	Shown	
Right of way, right to drain water & sewerage & to convey water, electricity & telecommunications	99	A	Lot 100
	100	B	Lot 99
	119	C, BD	Lot 120
	120	D, BE	Lot 119
	123	E, BA	Lot 124
	124	F, BB	Lot 123
	183	G	Lots 184-188 & 203
	184	H	Lots 183, 184, 186-188 & 203
	185	I	Lots 183-185, 187, 188 & 203
	186	J	Lots 183-186, 188 & 203
	187	K	Lots 183-186, 188 & 203
	188	L	Lots 183-187 & 203
	189	M	Lots 189-193
	190	N	Lots 189, 190, 192 & 193
	191	O	Lots 189-191 & 193
192	P	Lots 189-192	
193	Q	Lots 189-192	
203	R	Lots 183-188	
Right to drain water & sewerage	99	T	Lot 100
	190	AM	Lots 111-114
	180	AG	Lot 179
	181	AH	Lots 179 & 180
	182	AI	Lots 179-181
	107	AJ	Lot 179-182
	108	AK	Lots 179-182 & 107
	109	AL	Lots 179-182, 107 & 108
	190	N	Lots 179-182 & 107-114
	189	M	Lots 179-182 & 107-114
	191	O	Lots 179-182 & 107-114
	192	P	Lots 179-182 & 107-114
	193	Q	Lots 179-182 & 107-114
	123	AO, BA, BC	Lots 122 & 125
	124	AO, BC	Lot 124
122	BB	Lots 122 & 125	
119	S, BD	Lots 115-118	
120	BE, BF	Lots 115-118 & 121	
120	BF	Lot 119	
116	CE	Lot 115	
117	CF	Lots 115 & 116	
119	BD	Lot 121	
Right to drain water	404	CC, CD, CB, CG, CH, BF, BG, BH, BL, BJ, BK, BL, BM, BN	Lots 122-125 Lots 115-121 Lot 190 Lots 191 & 192 Lots 193 & 195
	404	CB, CH, BT, BL, BL, AV, BZ, BI, BI, BS, BR	Lots 115-121 Lot 195 Lot 193 Lot 192 Lot 191 Lot 190

PROPOSED MEMORANDUM OF EASEMENTS IN GROSS			
Nature	Servient Tenement (Burdened Land)		Grantee
	Lot No.	Shown	
Right of way on foot in gross	404	AR, AZ, BD, AS, BE, AT, BQ, AU, BA, BG, BJ, BM, BO, AV, BF, BI, BR, BS, BT, AW, BH, BK, BL, BN, BP, BU, AY, BV, BW, BX, BY, BZ, CA, CB, CC, CD	Christchurch City Council
	404	BP, BO	Christchurch City Council
Right to drain water in gross	404	BP, BO	Christchurch City Council

SCHEDULE OF EXISTING EASEMENTS			
Nature	Servient Tenement (Burdened Land)		Document
	Lot No.	Shown	
Right to drain sewage in gross	124	AN	Ei 8389206.1
	123	AO, AP	
	120	AQ	
	196	AX	
	404	AR, AZ, AU, BG, BJ, BM, BP, AY, BV, BW, BX, BY, BZ, CA, CB, CC, CD	

Comprised in: CFR.678532 (33.9482 ha)

DAVIE LOVELL-SMITH
 PLANNING SURVEYING ENGINEERING
 116 Wrights Road P O Box 679 Christchurch 8140. New Zealand
 Telephone: 03 379-0793 Website: www.dls.co.nz E-mail: office@dls.co.nz

JOB TITLE:
Westmorland Nominees Ltd.

SHEET TITLE:
**Stages 4, 5A, 5B & 6
 Proposed Subdivision
 of Lot 401 DP 482377**

DRAWING STATUS:
For Subdivision Consent

SCALE: 1:1000@A1 DATE: MAY 2021
 1:2000@A3

CAD FILE: J:\19599\OVERALL SUBCON R7.dwg REVISION:
 DRAWING No: E.19599.SC01 SHEET No: 1 of 1 **R7**

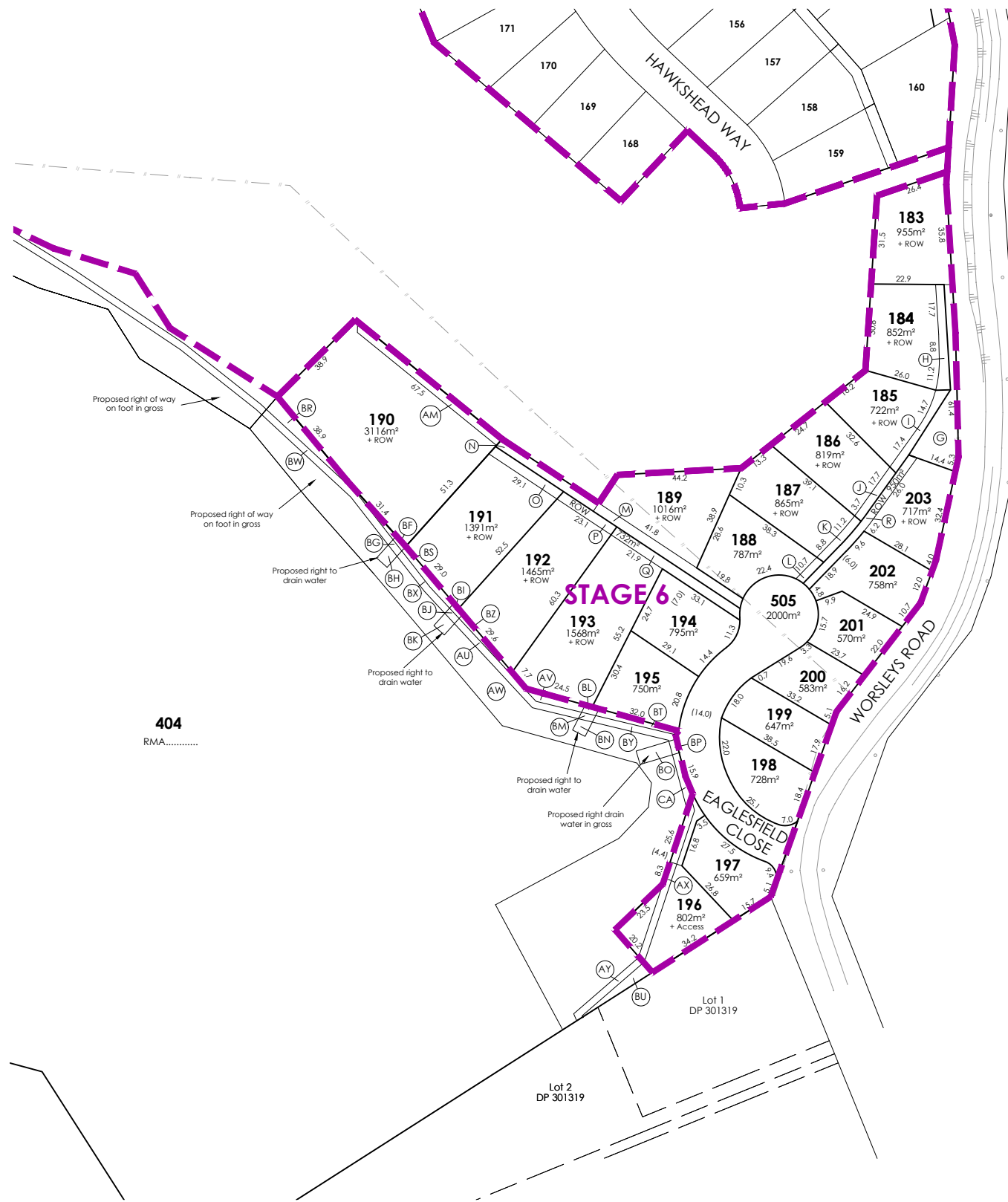
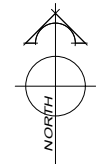

AMENDMENTS:		
AMENDMENT	DATE	DESCRIPTION
R1	6.3.19	NO CHANGE THIS SHEET
R2	27.9.19	EASEMENTS ADDED
R3	2.12.19	LOTS 196 & 197 AMENDED
R4	19.01.21	LOTS 196 & 197 AMENDED
R5	05.05.21	LOTS 183 - 188, 198 - 203 & 505 AMENDED

- NOTES:
- 1) Areas and dimensions are subject to final survey and deposit of plans.
 - 2) Service easements to be created as required.
 - 3) This plan has been prepared for subdivision consent purposes only. No liability is accepted if the plan is used for any other purpose.
 - 4) This plan has been prepared for the use of our client and no liability is accepted in relation to any other parties.
 - 5) Any measurements taken from information which is not dimensioned on the electronic copy are at the risk of the recipient.
 - 6) This plan is subject to the granting of subdivision and/or resource consents and should be treated as a proposal until such time as the necessary consents have been granted by the relevant authorities.

Refer to E19599 SC01 for Easement Details

Comprised in: CFR 678532 (33.9482 ha)



116 Wrights Road P O Box 679 Christchurch 8140. New Zealand
 Telephone: 03 379-0793 Website: www.dls.co.nz E-mail: office@dls.co.nz

JOB TITLE:
Westmoreland Nominees Ltd.

SHEET TITLE:
**Stage 6
 Proposed Subdivision
 of Lot 401 DP 482377**

DRAWING STATUS:
For Subdivision Consent

SCALE: 1:1000@A1 DATE: MAY 2021
 1:2000@A3

DRAWING No: J:\19599\E19599 STG 6 SUBCON R5.dwg REVISION:
 DRAWING No: SHEET No:
E19599.SC04 R5